

Legend

	Reinforced Concrete
	Lean Concrete
	Solid Brick Masonry
	Hollow Brick Masonry
	Ventilation Opening

- Room Number**
B06/05
FT 3
FFL ±0.000
- Floor Type 3 (Epoxy Floor)**
FFL ±0.000
Finished Floor Level
- K2**
W2
V1
D7
- Wooden Window 2 (Locally manufactured)**
Wooden Door Window 1 (Locally manufactured)
Wooden Ventilation 1 (Locally manufactured)
Horizontal Doors 7 (Imported)

AS-BUILT DRAWING

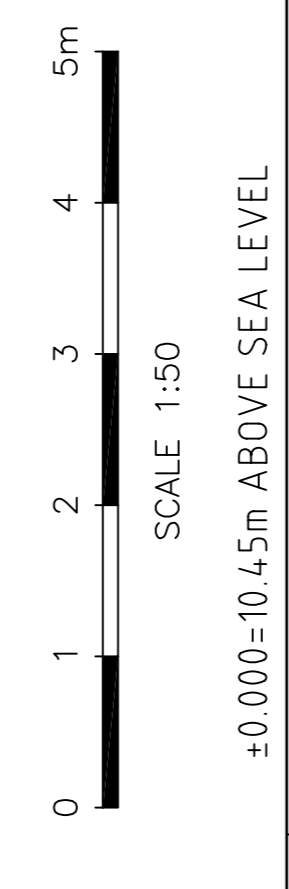

REFERENCES

DOCUMENT No.	DESCRIPTION

REVISIONS

No.	CHECK	APPR.	DATE	DESCRIPTION
E	REI		05/08/28	ASBUILT WALL
D	REI		05/08/28	
C	REI		05/08/28	
B	REI		05/08/28	
A	REI		05/08/28	

SONIA KILL MEMORIAL HOSPITAL FOR CHILDREN KAMPOT CAMBODIA

CONSULTING ENGINEERS
 Hons Hoff
 Pierre-Polm-Straße 17
 D-53639 Königswinter
 Tel: +49 2204 706 000
 www.hons-hoff.com

OPD (B06) FLOOR PLAN WEST WING

PROJECT No. ORG. SIZE ORG. SCALE
 602 AQ+190 1:50

DRAWING No. REV.
 D-B06-A1-02

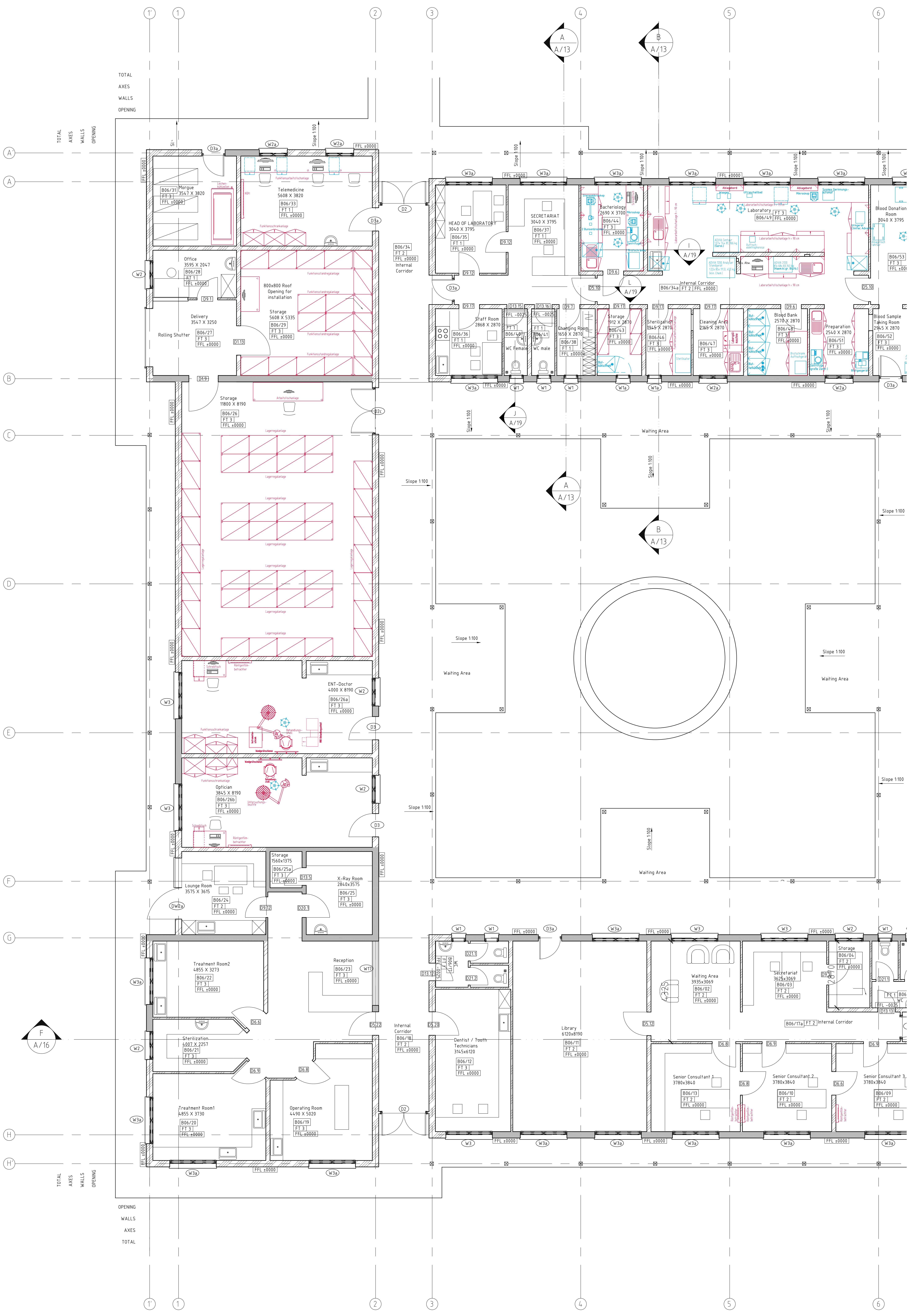

TOTAL AXES WALLS OPENING

TOTAL AXES WALLS OPENING